

Combining the best design
features into one solution



Manufactured locally in WA

**MAF - MINPROVISE APRON
FEEDER SERIES**



MINPROVISE

FORWARD THINKING PARTNERS

“

We have an excellent reputation amongst our clients for outstanding quality, performance, and safety initiatives. I take pride in introducing MINPROVISE to you as I truly believe we are one of the most capable, professional, and reliable companies in the industry.

Graham Townsend
MANAGING DIRECTOR

”

MINPROVISE is a specialist products, engineering and services company providing expert support to the mining, oil & gas, and construction industries.

This includes the supply of mineral processing equipment, onsite installations, maintenance & repairs, shutdowns, offsite repairs, and fabrication. Our suite of products covers mineral processing and bulk materials handling equipment along with other specialty products.

MINPROVISE was established in 2004 with a core business of reducing the risk associated with operating and maintenance of crushing equipment. In 2017 Minprovis was approached to support the specialist Apron Feeder maintenance market, and soon became the benchmark.

In 2020 Minprovis embarked on a journey to develop our own MAF – Apron Feeder Series, that would combine all the best design features on the market into one machine. With the primary focus on Safe maintainability.



DESIGN FEATURES

The experience and knowledge gained from decades of working with apron feeders as part of our ongoing crusher circuit maintenance and shutdown expertise, has enabled us to optimise certain features. These design features increase efficacy and ease of access improving maintenance processes while enhancing the safety of personnel and operators.

Innovative maintenance and safety features include:

- Segmented Sprockets for replacement without severing chains
- External Hydraulic Take-Up adjustment to allow adjustment without stoppage
- Integrated Lifting points for safer roller replacement
- Optional Composite Toolkit customized per machine
- Optional supply of purpose made Maintenance Platforms
- Optional Dribble Conveyor incorporated

FLEXIBLE DESIGN OPTIONS

The Minprovis Apron Feeder Series is designed to conform to all AS/NZ standards while being able to accommodate design adjustments and adaptations to suit specific needs and requirements of our customers without compromise.

Possible adjustments include:

- Forged solid one-piece Head Drive Shafts
- Composite Shafts with keyed Sprocket Hubs
- Electro-Mechanical Drive Units
- Hydraulic Drive Units
- Single or Dual Drives
- Hydraulic Take-Up Adjusters
- Mechanical Take-Up Adjusters
- Optional Modular Skirt systems incorporated or adapted to suit clients existing design
- Optional Guarding incorporated

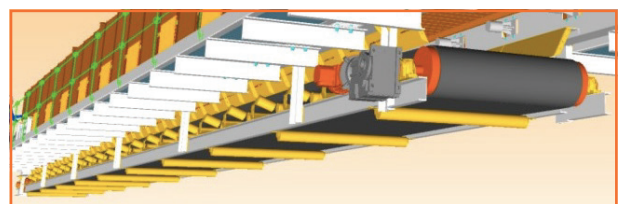
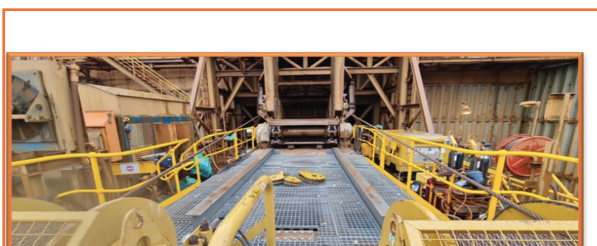
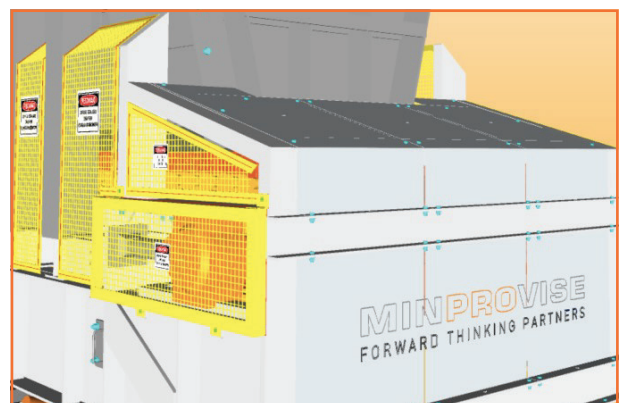
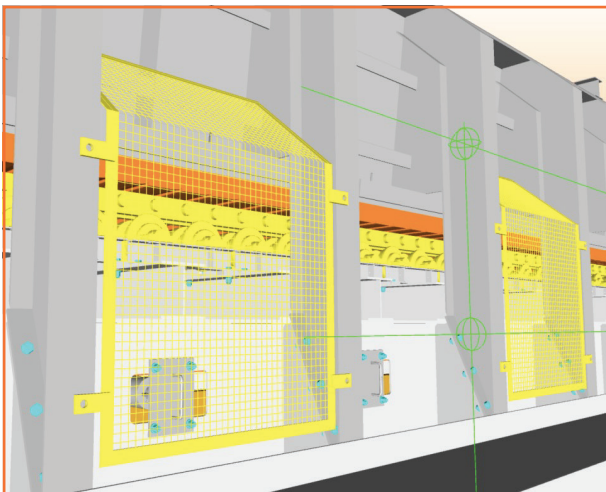

LOCALLY MANUFACTURED

Minprovis is a West Australian owned and operated company. Our Head Office and fabrication workshop is located in Welshpool, where the Apron Feeder range is manufactured. We aim to support local suppliers by sourcing components locally.

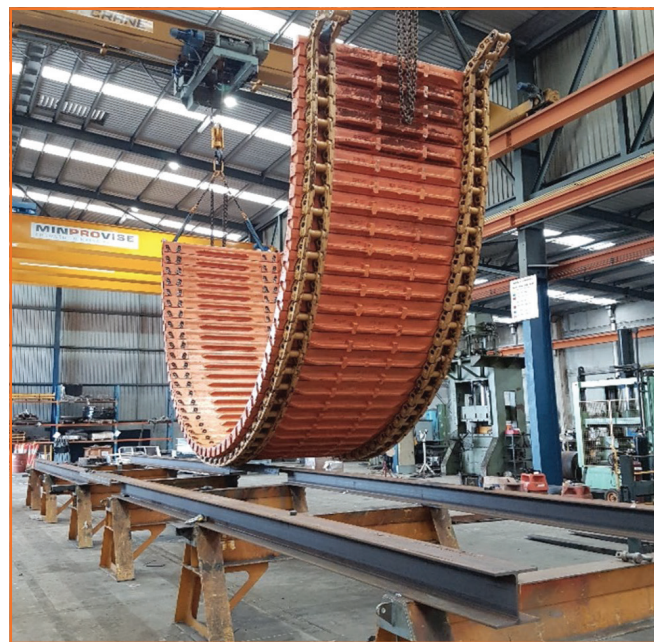

APRON FEEDER FLIGHTS/PANS

Our Pans are designed to suit the unique requirements of each application. They are available in various sizes and are cast as "Standard" or "Riser-Bar" units. Additionally, our Pans are cast with a stiffener rib on the underside that incorporates slipper pads to support material weight and add strength to the Pans.



Our Pans are available in cast Manganese AS2074/H1A; AS2074/H1B and AS2074/LS being the most popular material preferences. Special castings, with a variety of blends, are available on request.

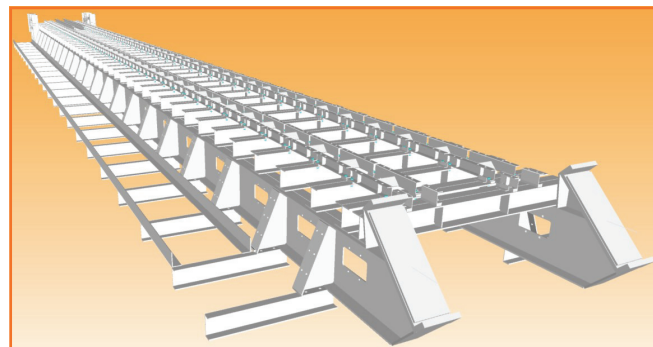

APRON FEEDER CHASSIS

Design, drafting and manufacturing is all done in-house to suit the specific requirements of the project.

Feeder Speed (m/min)	Pan Load Width							
	1000		1200		1500		1800	
	m ³ /h	t/h	m ³ /h	t/h	m ³ /h	t/h	m ³ /h	t/h
2	51	82	78	125	126	202	182	291
4	103	164	157	251	252	404	364	583
6	154	246	235	376	378	606	546	874
8	205	328	314	502	505	807	728	1165
10	257	411	392	627	631	1009	910	1456
12	308	493	470	753	757	1211	1092	1748

Feeder Speed (m/min)	Pan Load Width							
	2000		2400		2600		2800	
	m ³ /h	t/h	m ³ /h	t/h	m ³ /h	t/h	m ³ /h	t/h
2	229	366	343	548	407	652	472	755
4	457	732	686	1097	815	1304	943	1509
6	686	1098	1028	1645	1222	1956	1415	2264
8	915	1464	1371	2194	1630	2607	1887	3019
10	1144	1830	1714	2742	2037	3259	2359	3774
12	1372	2196	2057	3291	2444	3911	2830	4528

APRON FEEDER PANS & RUNNING GEAR

Minprovis Apron Feeder Pans are an Original Equipment Manufacturer (OEM) equivalent product that includes full Quality Assurance and Quality Control documentation.

Inhouse design capabilities, allows us to draw up new design drawings for your existing Apron Feeders.

We offer excellent quality castings at highly competitive pricing, at reasonable delivery times. Minprovis can also supply all other running gear, including:

- Chains D3 – D11 (SALT & Standard)
- Sprockets – Design and manufacture
- Carry and Return Rollers
- Impact rails
- Wear Plates for skirts and hoppers
- Manufactured Pans



APRON FEEDER SERVICE & SUPPORT CAPABILITIES

Minprovis's Apron Feeder service and support capabilities include everything from Comprehensive Audits to complete refurbishments of the Apron Feeder and ancillary equipment. Our aim is to continually improve safety and identify efficiencies in processes, costs and improve downtime.

AUDITS

- Provide the client with an accurate position of the current condition of all the running gear and allows for the planning and procurement of long lead items
- Detailed report will highlight component and equipment condition and outline recommendations for ongoing maintenance and improvements



MAINTENANCE

Minprovis are experienced specialists in the maintenance and servicing of Apron Feeders and associated ancillary equipment. We offer a complete and comprehensive service that covers:

- Design and Engineered drawings
- Project Management from Conception to Hand-over
 - Initial inspection, planning and pre-engagement to ensure all options are covered and improvement methods investigated
 - Provision of a full methodology SWP's and Gantt
 - A detailed report on work completed including, ITPs and any "Opportunities to Improve"
- Break-in works, as required
- Specialised tooling
- Technical Support and Advice

MINPROVISE

FORWARD THINKING PARTNERS



**CONTACT US AND TALK TO
OUR APRON FEEDER SPECIALIST TODAY**

LOUW SCHOLTZ

Product Specialist, Apron Feeders

Mobile: +61 488 004 192

Email: louw.scholtz@minprovis.com.au

Address: 50 Murray Road North, Welshpool, WA 6106

Web: www.minprovis.com.au